

**CITY OF FAIRVIEW  
BOARD OF COMMISSIONERS**

**SEPTEMBER 3, 2020**

**7:00 P.M.**

**AGENDA**

- 1. Roll Call**
- 2. Call to Order**
- 3. Prayer and Pledge**
- 4. Approval of Agenda and Executive Session Announcements**
- 5. Public Hearing(s)**
- 6. Citizen Comments** (Limited to the first 5 citizens to sign in and a limit of 3 minutes each)
- 7. Public Announcements, Awards and Recognitions**
- 8. Staff Comments and Monthly Reports**
  - A. City Manager Report
- 9. Consent Agenda** (Any Item May be Removed for Individual Consideration)
  - A. Minutes from the August 20, 2020, Board of Commissioners Meeting
  - B. Minutes from the August 20, 2020, Board of Commissioners Work Session
- 10. Old Business**
- 11. New Business**
  - A. Playground Design Concept Approval
  - B. Resolution 19-20, A Resolution of the City of Fairview, Tennessee, Authorizing the Mayor to Execute an Extension of Contract 16687 Relating to the Bowie Lake Road to Park Village Court Sidewalk Project
  - C. Resolution 20-20, A Resolution of the City of Fairview, Tennessee, Designating a Vehicle and Equipment as Surplus, and Authorizing the Disposal of These Surplus Items
- 12. Communications from the Mayor and Commissioners**
  - A. Commissioner
  - B. Commissioner
  - C. Commissioner
  - D. Vice Mayor
  - E. Mayor
- 13. Meeting Adjournment**



## Bowie Park Playground Rebuild Proposal

Presented by:  
City of Fairview Parks & Landscaping Board  
&  
Bowie Park Playground Rebuild Citizens  
Group



## Contents

Executive Summary .....	3
Survey Results Summary .....	4
Equipment and Design Features .....	5
Maintenance Plan and Costs .....	16
Warranty Information .....	17
Phased Build Approach.....	22
Build Timeline.....	23
Pricing Quotes .....	24
Community Build Scenario – Construction Options.....	28
Fundraising Projections .....	32

## Executive Summary

The Parks and Landscaping Board have worked with the Bowie Park Playground Rebuild Group (a citizens group) to explore and develop this proposal for a replacement playground at the City of Fairview's Bowie Park.

We present this proposal to the BOC for their review, consideration, and feedback.

If the City were to choose to pursue this path, the Playground Rebuild Group would shift their focus to the fundraising phase of the project.

### Actions Timeline

- July 6, 2019 – Treehouse playground removed due for safety concerns
- September 5, 2019 – BOC accepts proposal to allow the Parks and Landscaping Board to receive proposal from Bowie Park Playground Rebuild Group (a citizens group) for a replacement playground at Bowie Park in Fairview.
- August-September 2019 – Child Playground Survey (437 respondents)
- October 16, 2019 – First meeting of Bowie Park Playground Rebuild Group – vendor presentations
- August-October 2019 – Adult Playground Survey (820 respondents)
- November 6, 2019 – Vendor presentations
- November 16, 2019 – Playground tours (8 area playgrounds)
- December 11, 2019 – Vendor presentations
- January 18, 2020 – Playground Design Development Meeting and RFP crafting
- February 14, 2020 – RFP sent to 5 vendors
- March 16, 2020 – RFP responses collected
- *Covid 19 – stalls meetings/progress*
- May 21, 2020 -RFP review and follow-up questions meeting
- June 16, 2020 – Vendor refinement – zoom Meeting
- June 17, 2020 – Vendor refinement – zoom Meeting
- July 19, 2020 – Proposal development – zoom Meeting
- August 13, 2020 – Proposal refinement – zoom meeting
- August 19, 2020 – Parks and Landscaping Board Meeting – review/approve to present to BOC
- August 20, 2020 – P&L Proposal presentation to BOC

## Survey Results Summary

Name the top three play and/or physical activity components that you would like to see included in the future park design.

Most popular components, all respondents

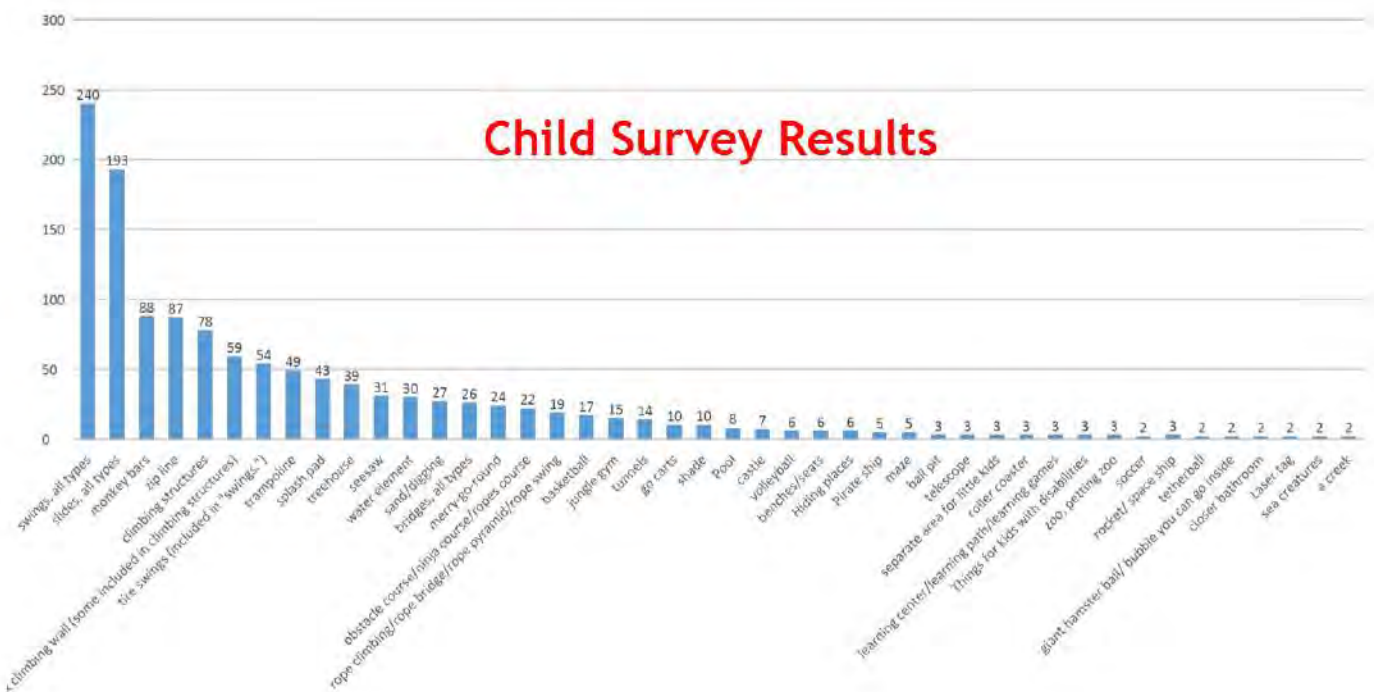
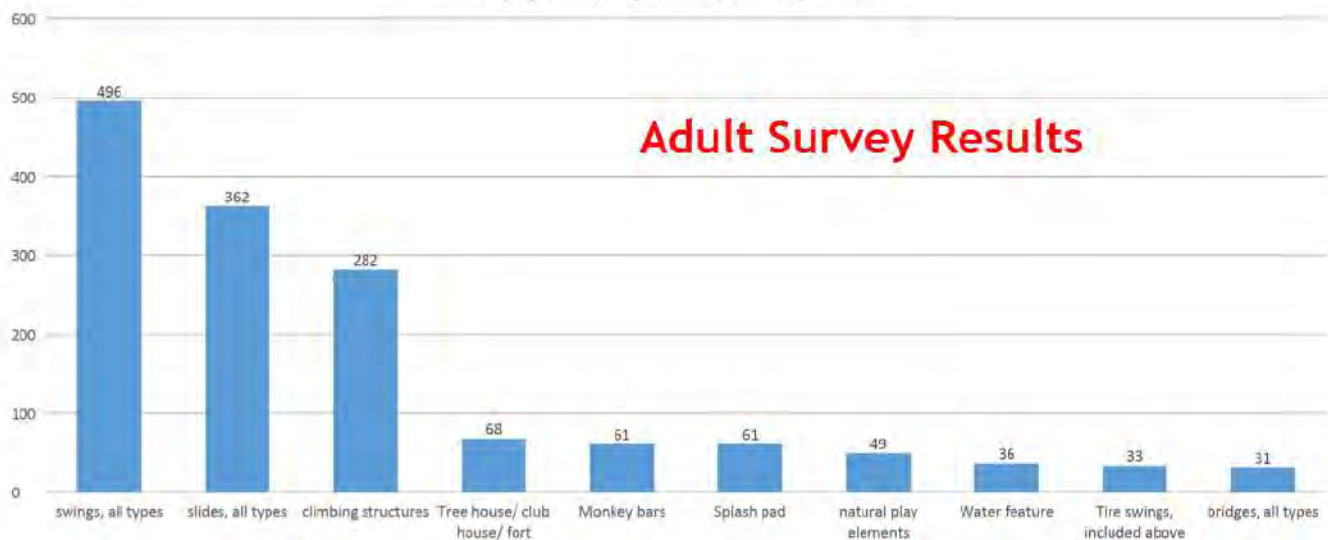

## Equipment and Design Features

Design Renderings/Equipment Info/Design ADA Compliance



**Bowie Park  
Playground Renovation**



Licensed General Contractor: TN\_AL\_VA\_NC\_SC\_MS

Operate in GA\_TN\_AL\_VA\_NC\_SC\_MS\_KY\_FL

Specialize In The Design/Build of Recreational Spaces - Specifically  
Playgrounds and Splash Pads

Self-Perform With 3 GSR Crews Comprised of 12 Installers.

Bond Rate: 2% Bond Capacity: \$3M GLI: \$2M

---

CAPACITY

---

# GSR Design Theory

**Born from the experience of 19 kids and counting.**

- Play is not taught, it is discovered through experience.
- Children need an un-prescribed play space to explore, invent and create.
- A truly inclusive community play space will address the needs of the entire community.
- A dreamy play space should not be a maintenance nightmare.

## DESIGN THEORY









**Berliner Neptun.20 Climber**



**Dual Zip Line with ADA Seat  
and Standard Zip Seat**

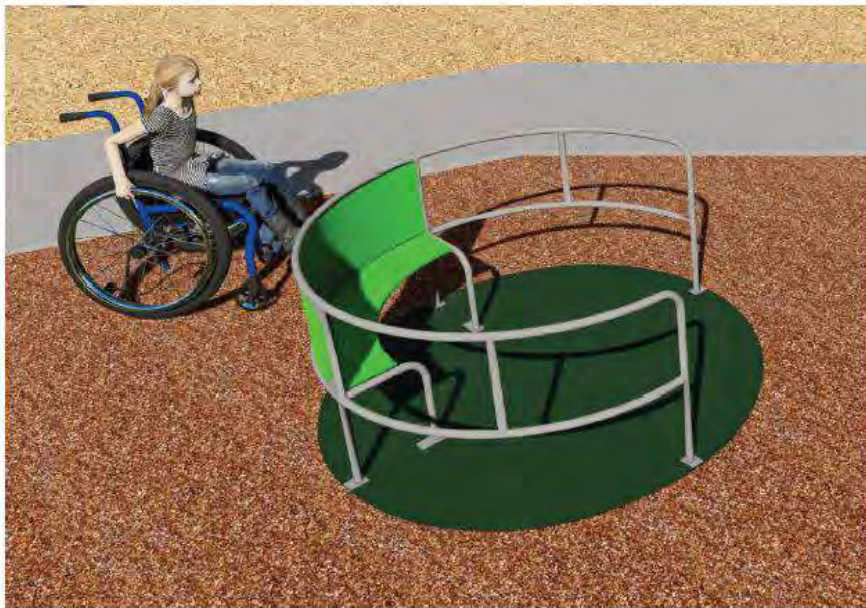

**Friendship Spinner - Ground  
Level Wheelchair Accessible**



**5 to 12 year old Ramped Treehouse Structure**





2 to 5 year old Treehouse Structure





**3-Bay Swing with Tire and  
Belt Seats**



**ID Sculptures GFRC  
Balance Log**



**ID Sculptures GFRC  
Bear Cub**



**2-Bay Swing with toddler,  
parent/child and ADA swing  
seats**



**Multi-Spring Forest Service  
Play Truck**

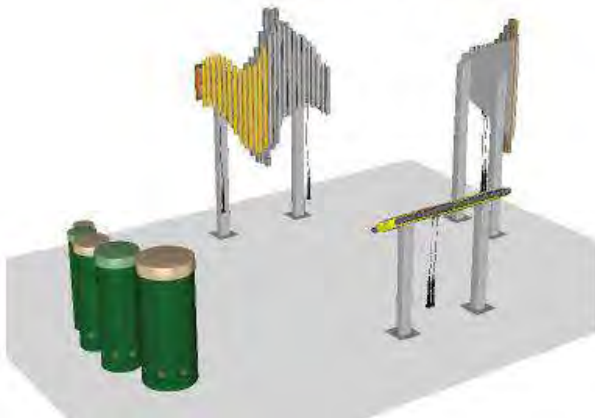

**Freenotes Instruments**



**(5) 6' Long Double-Sided Benches  
spaced ~ 4' Apart**

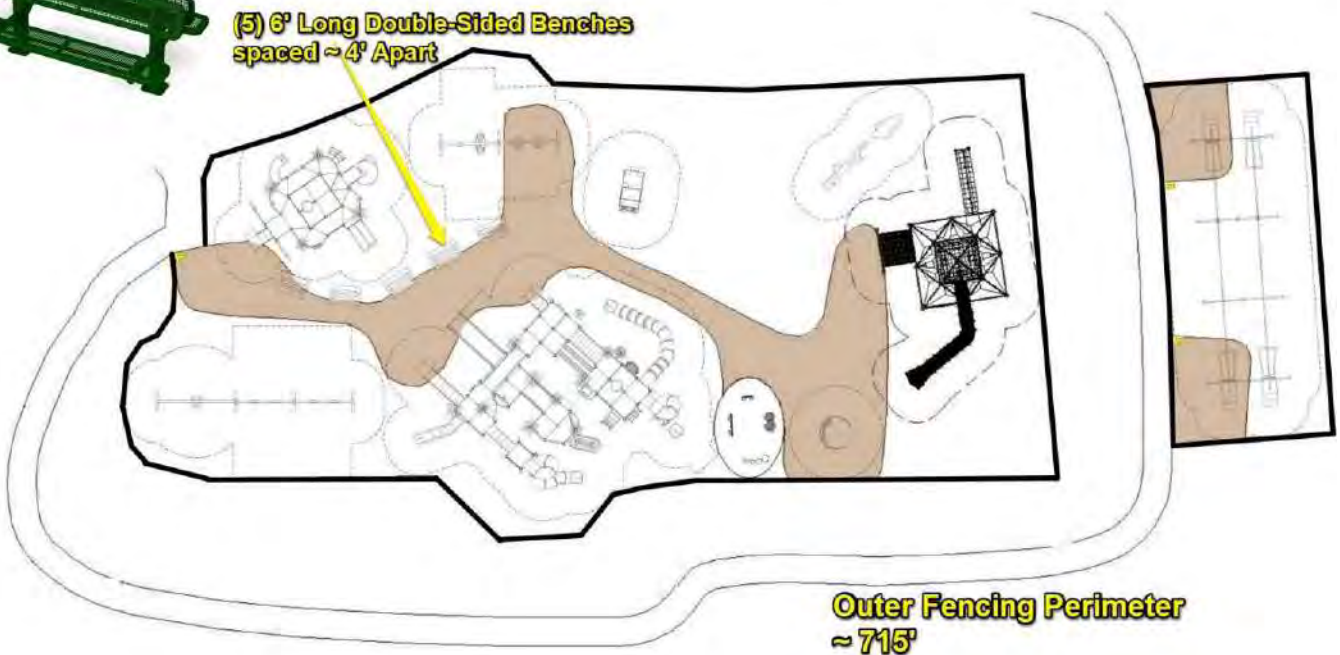

**Outer Fencing Perimeter  
~ 715'**

**BENCH LAYOUT OPTION**

## Bowie Park - ADA Chart Structures



### Elevated Components

5-12YR Structure - 30

2-5YR Structure - 13

Rope Climber - 3

**Total: 47 Elevated**

### Accessible Components

5-12YR Structure - Elevated (Required) - 27 (15)

5-12YR Structure - Ramp Accessible (Required) - 9 (8)

5-12YR Structure - Ground (Required) - 8 (13)

2-5YR Structure - Elevated (Required) - 9 (7)

2-5YR Structure - Ground (Required) - 5 (4)

Rope Climber - Elevated (Required) - 0 (2)

**Accessible Elevated Total (Required): 36 (24)**

**Ground Level Total (Required): 13 (17)**

**Ramp Accessible (Required): 9 (8)**



## Maintenance Plan and Costs



**Our approach to true play partnership.**

### **Our Partner Package for Bowie Nature Center Includes:**

- Manufacturer and Labor backed warranties. If a component fails before the warranty period ends, GSR will include labor to rectify the issue at no additional cost.
- Day one safety certification with drop testing reports for the safety surfacing to be conducted by our Director of Safety, Ben Bowden.
- Five Year Worry Free Plan that includes;
  - Yearly Maintenance Check.**
  - Coverage for any missing or broken hardware.**
  - Replacement of Swing Bushings during the initial 5 year period.**
  - EWf surfacing top off every 18 months for the first 5 years.**
- Along with the 5 year partner plan, we would like to extend an on call emergency labor option for any matters that fall outside of our included partner plan. The rate for a minimum of two laborers would be \$100.00/hour.

### **Estimated Maintenance:**

30 minutes to 1 hour/month to rake mulch and perform a visual walk through for the life of the playground (recommended but optional).

Years 0-5 you have the partner program, manufacturer and labor backed warranties.  
Years 0-15 you have the manufacturer and labor backed warranties.

Approximately 4" mulch top off per 18 months after year 5. Approximately \$32/cubic yard - \$4200 per top off.

## Warranty Information

### Warranty/Maintenance Info



**WARRANTY** - Great Southern is provide to provide the South's **ONLY Lifetime Labor Warranty** to back up all of our equipment manufacturer warranties. You will find a full description in the following pages but this warranty provides the required labor to replace any playground product covered under the manufacturer's warranty. Example - Your molded slides have a 15 year warranty. If the slide breaks in year 7 due to a manufacturer defect, Great Southern will receive the new slide, remove/dispose the old one and install the new slide at **NO CHARGE** to the City. You will also find warranty information from our manufacturers in the following pages.

**MAINTENANCE** - Maintenance is a natural part of playground ownership. However, it shouldn't strain your resources to the point that the playground falls in disrepair. For the this reason, Great Southern is proud to offer the City of Fairview a 5 year maintenance package is included in each option. This starts at Day 1 as it includes a playground HIC test to give the City official documentation and peace of mind to know that from Day 1, their safety surfacing provides all the protection it is required to by the ASTM/CPSC guidelines. This also includes a full safety inspection by our Safety Director, Ben Bowden before the playground keys are turned over. Then, during the first 5 years, a Great Southern Representative will complete a Low-Frequency Audit and Maintenance Check of the Bowie Playground on its yearly anniversary. This inspection will provide the City with any maintenance/repair items that may need to be addressed and a solution for them. Additionally, we are including coverage of any missing or broken hardware (there's a lot of bolts on a playground that size!) at **NO COST** to the City. The swing bushings will likely need to be replaced every 2-3 years and Great Southern will include replacement of those bushings as necessary in the first 5 years of ownership. After 5 years, the City always has the option to purchase an extended maintenance agreement.



---

## CERTIFIED SOUTHERN-BUILT™ INSTALLATION

---

An official proposal from Great Southern isn't limited to parts from a catalog. We've made a plan for the long-term performance and legacy of the space you're building. You'll want to make sure your playground is Southern-built™.

**Exclusive GSR Labor-backed Warranty:** Your warranty doesn't stop with the manufacturer. We match their warranty with one of our own. While a warranty scenario is rare, you won't be stuck installing parts yourself and left to hope the repair is compliant with federal guidelines. GSR will ship your warranted parts and perform the replacement... for the entire life of the warranty.

**The Team Approach:** We don't dump your project on an installer you've never met. In all phases of your project you'll have full access to your personal Territory Manager, GSR Safety and Operations Manager, Lead Installers, President and Company Owner.

**Personal Investment:** Everyone connected to your project is personally invested and follows the GSR mantra of being proud of the work they leave behind.

**Compliance:** Your installation will be completed by certified professionals holding an up-to-date CPSI certificate. Whether our in-house crews or a certified subcontractor we've worked with for years, you're in good hands. Your playground will be in compliance with all ASTM, CPSC and ADA guidelines.

**Truly turn-key:** Your installation includes shipping, unloading, staging, assembly and finishing. When we say "turn-key", we won't send you a list of exclusions and things you're responsible for.

**YOU'RE IN THE RIGHT PLACE. YOUR BETTER WORLD, STARTS RIGHT HERE.**

---

[GreatSouthernRec.com](http://GreatSouthernRec.com)

1-800-390-8438

[Info@GreatSouthernRec.com](mailto:Info@GreatSouthernRec.com)

---

# PLAYCRAFT SYSTEMS WARRANTY

Krauss Craft, Inc., the manufacturer of Playcraft Systems, warrants its products to be free from defects in materials or workmanship, when properly used, serviced and installed in accordance with published specifications, for a period of one (1) year from the original date of invoice.

Krauss Craft, Inc. further warrants as follows:

## **LIFETIME LIMITED WARRANTY**

on all stainless steel hardware, metal posts, aluminum posts, aluminum caps and aluminum clamps against structural failure due to natural deterioration or corrosion, or defects in materials or workmanship.

## **TWENTY-FIVE (25) YEAR LIMITED WARRANTY**

on all cast aluminum Spring Rider castings against structural failure due to defects in materials or workmanship.

## **FIFTEEN (15) YEAR LIMITED WARRANTY**

on all metal rails, metal slides, handles, rungs, loops and walls, all Play-Tuff™ coated perforated steel decks, steps, and bridges, all rotationally molded and HDPE sheet plastic components, excluding recycled plastic components, against structural failure due to defects in materials or workmanship.

## **TEN (10) YEAR LIMITED WARRANTY**

on all shade canopy fabric made of UV Stabilized HDPE monofilament yarn and tape against significant fading.

## **TEN (10) YEAR LIMITED WARRANTY**

on all Play-Cord™ components against breakage.

## **FIVE (5) YEAR LIMITED WARRANTY**

on all Play-Cord™ components against failure due to defects in materials or workmanship.

## **THREE (3) YEAR LIMITED WARRANTY**

on all springs, moving swing parts, swing seats and other swing components, as well as all recycled plastic components against failure due to defects in materials or workmanship.

## **ONE (1) YEAR LIMITED WARRANTY**

on any other product or part not specifically covered above against failure due to defects in materials or workmanship.

All warranties above commence on the date of the original invoice from Krauss Craft, Inc. For the purpose of this warranty, the term LIFETIME encompasses no specific number of years, but rather that Krauss Craft, Inc. warrants to its original customer, for as long as the original customer owns the Products and uses the Products for their intended purpose, that any Products and all components will be free from defects in materials or workmanship.

The warranty stated above is valid only if: (1) the products and structures are assembled and installed in conformity with the layout plan and installation instructions furnished by Krauss Craft, Inc.; (2) the products have been maintained and inspected in accordance with Krauss Craft's maintenance information and other normal and prudent practices; (3) the products have been subjected to normal use for the purpose for which the products were designed and intended; (4) the products have not been subjected to misuse, abuse, vandalism, accident or neglect; (5) the products have not been altered in any manner including, but not limited to, incorporating unauthorized or unapproved parts, and (6) the products have not been modified, altered, or repaired by persons other than Seller's designees in any respect which, in the judgment of Seller, affects the condition or operation of the equipment.

This warranty does not cover: (1) cosmetic damages or defects resulting from scratches, dents, marring, fading, discoloring or weathering; (2) damage due to extreme or prolonged exposure to "Environmental Factors", such as wind-blown sand, salt water, salt spray and airborne emissions from industrial sources (sulfur, acids or corrosive chemicals, other than normal photochemical smog); (3) damage caused by "Acts of God", such as hail, flooding, lightning, tornadoes, sandstorms, earthquakes, windstorms, and other extreme weather conditions; or (4) normal wear and tear. If any products covered by this warranty fail within the time period applicable to a defective product, Krauss Craft, Inc. shall, upon being notified of the defect in writing, at its sole option, either repair the defective products or replace the defective products within 30 days of receipt of the written notification.

Repair or replacement as provided in this section shall be the purchaser's exclusive remedy and purchaser expressly agrees that Krauss Craft shall not be responsible for any other damages, losses, or costs, including consequential and incidental damages, claimed by purchaser. Krauss Craft, Inc. shall deliver the repaired or replacement products to the purchaser free of charge, but shall not provide labor, reimbursements for labor or reimburse any other costs associated with the removal or disposal of the defective products and/or the installation of any replacement products. Notwithstanding the previous sentence, Krauss Craft, Inc. shall not pay for any costs of shipping replacement parts outside of the continental United States. Any products replaced or repaired consistent with this paragraph shall be guaranteed for the balance of the original warranty period.

THIS WARRANTY IS EXCLUSIVE AND IS IN LIEU OF ALL OTHER WARRANTIES, WHETHER EXPRESSED OR IMPLIED, INCLUDING BUT NOT LIMITED TO ANY WARRANTY OF MERCHANTABILITY OR FITNESS FOR A PARTICULAR PURPOSE. THE REMEDIES PROVIDED HEREIN SHALL BE THE EXCLUSIVE AND SOLE REMEDIES OF THE ORIGINAL PURCHASER. KRAUSS CRAFT, INC. IS NOT LIABLE FOR ANY SPECIAL, DIRECT, INDIRECT, INCIDENTAL OR CONSEQUENTIAL DAMAGES WHICH MAY ARISE FROM THE PURCHASE, USE OR MISUSE OF ITS PRODUCTS. SOME STATES DO NOT ALLOW THE EXCLUSION OF INCIDENTAL OR CONSEQUENTIAL DAMAGES, SO THIS EXCLUSION MAY NOT APPLY. KRAUSS CRAFT, INC. NEITHER ASSUMES NOR AUTHORIZES ANY OTHER PERSON TO ASSUME OR IMPLY ANY OTHER LIABILITY IN CONNECTION WITH THE SALE OR USE OF THE EQUIPMENT SOLD.

To make a claim under the terms of this warranty, purchaser must submit a written statement detailing the nature of the warranty claim, including an itemization of each defective condition, along with a copy of the original invoice, maintenance records and supporting photographs to Krauss Craft, Inc., 123 North Valley Drive, Grants Pass, Oregon 97526.

Due to our on-going commitment to product development and improvement, Krauss Craft, Inc. reserves the right to change, modify or discontinue certain products without notice. (Rev. M)

# Berliner

## Warranty Certificate

**Lifetime\* Limited Warranty** from date of invoice on steel support posts against structural failure due to corrosion, deterioration or manufacturing defects.

**15 Year\* Limited Warranty** from date of invoice on all steel components, rails, loops, tubes, rungs, HDPE panels and components and aluminum connectors against structural failure due to corrosion, deterioration or manufacturing defects.

**10 Year\* Limited Warranty** from date of invoice on all HDPE slides against breakage.

**8 Year\* Limited Warranty** from date of invoice on all timber components against breakage.

**5 Year\* Limited Warranty** from date of invoice on ropes, bamboo, polyethylene and rubber components against structural failure or defects in material or workmanship.

**2 Year\* Limited Warranty** for all moving parts and bearings.

**One Year Warranty\*** Berliner Seilfabrik warrants that all product or equipment purchased will be free from defects in workmanship or materials for one year from the date of invoice. Berliner Seilfabrik will repair or replace the parts of the product or equipment found to be defective free of charge.

#### \*Items not covered in the above Warranties

Product or equipment that is not installed in conformity with installation instructions provided by Berliner Seilfabrik; product or equipment that has not been maintained and inspected in accordance with Berliner Seilfabrik's instructions; product or equipment that has been subjected to misuse, negligence or accident; product or equipment that has been subjected to addition, modification, alteration, repair, or part substitution by persons other than Berliner Seilfabrik or Berliner Seilfabrik's designees. Labor or damages resulting from vandalism, abnormal use, incorrect installation, and lack of maintenance are not covered by the above warranties. These warranties do not include any or all of the following cosmetic issues: scratches, dents, normal wear and tear, marring, deformation and cracking of timber and bamboo, fading of colors, discoloration, and natural fading. The above warranties are exclusive and lieu of all other warranties, whether expressed or implied, including, but not limited to any warranty of merchantability or fitness for a particular purpose. Further, no representation, oral or written, of any representative of Berliner Seilfabrik may be substituted for the afore described limited warranties. To the extent permitted by law, Berliner Seilfabrik shall not be liable, direct, indirect, special, incidental, or consequential damages which are expressly excluded from the above warranties.

\*Any freight costs associated with the warranty claim, any costs for dismantling the defective part in order to replace it, and any installation costs associated with the replacement part(s) are not considered part of this warranty and will not be paid by Berliner Seilfabrik. This warranty excludes liability other than that expressly stated, including but not limited to any incidental or consequential damages.

\*For the purpose of this warranty, the term lifetime encompasses no specific term of years, but rather that the seller warrants to its original customer for as long as the original customer owns the product and uses the product for its intended purpose that the product and all parts will be free from defects in material and manufacturing workmanship.

#### Warranty under Coastal or Chloric Conditions

Environments near sea water or chloric water can be extremely corrosive. Even with the appropriate maintenance, products installed in this environment will typically deteriorate more than products installed in a less severe environment. Some corrosion and/or deterioration is considered "normal wear" in this environment. Any claim for finish failures or for corrosion of other components is not applicable to the above warranty if the installation is in direct contact with chloric water or marine water including water spray. Installations being not in direct contact with marine water but within 220 yards of a sea coast require extra maintenance. Regular documented evidence of washing down with clean water is required for a limited warranty to be considered.

#### Warranty Claims

To be valid, all warranty claims must be submitted in writing promptly following discovery of the defect(s) and within the specified warranty period. Berliner Seilfabrik requires that all warranty claims be accompanied by a copy of the original invoice and photograph(s) clearly identifying the defect(s) in question.

#### Product Replacement

Berliner Seilfabrik continually improves its products and equipment and reserves the right, when replacing products or parts, to make approved substitutions in design or specifications.

#### Loss or Damage in Transit

Berliner Seilfabrik cannot be responsible for the loss or damage of products by common carriers. After the product departs our plant(s), we are no longer responsible for any loss, damage, or shortage.

**David Koehler, President**  
Berliner Seilfabrik Play Equipment Corporation





## **Freenotes Harmony Park Warranty**

Our Outdoor Musical Instruments are designed for durability and playability. We are confident that they will withstand all types of normal weather conditions and normal frequent play. They will never need re-tuning and can be enjoyed by all, any age or ability.

All Freenotes Harmony Park ("FHP") instruments will be built to our documented procedures and with the highest quality. Our warranty provides that our products will be free of defects in manufacturing and material.

Warranty begins on date of shipment. If any failures in manufacturing or materials occur within the applicable warranty period, FHP will provide replacement parts or products as determined by FHP within 30 days after written notification.

**All FHP products carry a 5-year limited warranty on all standard/stock instruments and posts. All custom instruments and posts carry a 90 day warranty.**

This warranty is valid for purchases on or after January 1, 2016.

This warranty is valid only if the mounting/assembly and ground/foundation works are carried out as described in the Installation Instructions of your FHP products and maintained according to the maintenance instructions provided by FHP. For all warranty issues it is the responsibility of the customer to cover all shipping costs, when necessary, for warranty items. FHP will not be responsible for providing labor or labor costs for the replacement of products or parts.

All replacement parts or products will be covered for the duration of the original warranty.

All products must be inspected immediately upon arrival. It is your responsibility to note any shipping damage on all copies of shipping paperwork. You must report any damage within 48 hours to Freenotes Harmony Park or to your FHP distributor. Damage not reported within this time frame cannot be covered under warranty.

### **FHP cannot warrant against:**

Theft, vandalism, misuse, negligence or accident.  
Scratches on paint, aluminum, or any finishes.  
Cosmetic issues or wear and tear from normal use.

# Phased Build Approach

## Phase 1

- 5-12YR Treehouse Structure
- 2-5YR Treehouse Structure
- 5-12YR 3-bay swing
- 2-5YR 2-bay swing (ADA Seat swing area)
- 3 of the 6 park benches to be used as perimeter seating
- Wood Mulch
- Bonded Rubber
- Borders

## Phase 2

- Rope Climber
- Remaining 3 of 6 benches used as perimeter seating
- Wood Mulch
- Bonded Rubber
- Borders

## Phase 3

- 2-12YR Multi-Spring Rider
- Freenotes Music Instrument Area
- Friendship Spinner
- GFRC Bear and Balance Log

## Phase 4

- Double Zip Line
- Wood Mulch
- Bonded Rubber
- Borders

## Build Timeline

### Full Build – Entire Turnkey Design

***12-14 weeks from time of order***

Berliner net climber has a longer lead time (an additional 2-4 weeks) but we would normally begin installation on the rest of the equipment and install the rope climber when it arrives.

- Installation time about 4 weeks with decent weather could extend to 6 weeks if weather delay
- Play equipment layout and installation - 2-4 weeks
- Border/Perimeter construction and rubber surfacing substrate - 1 week
- Rubber Surfacing and wood mulch installation - 1 week

### Phased Build Timeline

#### Phase 1

***10-12 weeks*** - similar to the turn-key install layout above, with a 1-2 week reduction off the full timeline above (minus 2-4 weeks for the rope climber)

#### Phase 2

***14-16 weeks*** - production/delivery for the rope climber. 2-3 weeks installation total (1 week for rope install, 1 week for additional surfacing and an extra week for weather)

#### Phase 3

***10-12 weeks*** - equipment production/delivery and 2-3 weeks installation

#### Phase 4

***8-10 weeks*** - equipment production/delivery and 2 weeks installation



## Pricing Quotes

*Pricing subject to 7% annual increase (estimated annual price increase from manufactures)*

**Full Build Turnkey - \$640,281.75**

**Partial Community Build - \$625,639.25**

**Full Community Build - \$520,464.35**

### **Phased Turnkey Build**

#### **Phase 1 - \$400k**

- 5-12YR Treehouse Structure - \$249,852
- 2-5YR Treehouse Structure - \$81,606
- 5-12YR 3-bay swing - \$12,157
- 2-5YR 2-bay swing (ADA Seat swing area) - \$12,187
- 3 of the 6 park benches to be used as perimeter seating - \$2,645
- Wood Mulch (327 yards) - \$14,511
- Bonded Rubber - \$27,263
- Borders - \$8,190

#### **Phase 2 - \$106k**

- Rope Climber - \$89,496
- Remaining 3 of 6 benches used as perimeter seating - \$2,645
- Wood Mulch (44 yards) - \$2,168
- Bonded Rubber - \$11,656
- Borders - \$2,730

#### **Phase 3 - \$87k**

- 2-12YR Multi-Spring Rider - \$11,510
- Freenotes Music Instrument Area - \$31,446
- Friendship Spinner - \$24,520
- GFRC Bear and Balance Log - \$21,752

#### **Phase 4 - \$51k**

- Double Zip Line - \$36,149
- Wood Mulch (75 yards) - \$3,253
- Bonded Rubber - \$9,471
- Borders - \$2,730

*Fencing (wood fence) estimated at \$39k....still researching non-wood options*

Full Build Turnkey



1-800-390-8438  
www.GreatSouthernRec.com

Beautiful Outdoor Spaces, we can ALL be proud of.

<b>ORGANIZATION:</b>	Bowie Nature Park Playground Committee
<b>CONTACT:</b>	Scott McCoy
<b>ADDRESS:</b>	7100 City Center Circle, Fairview, TN 37062
<b>PHONE:</b>	615-799-2002

<b>PROJECT TITLE:</b>	Bowie Park Replacement
<b>REVISION:</b>	1
<b>OPTION:</b>	1 - Turn-Key

**Official Quote from Great Southern Recreation**

TERRITORY MANAGER	DATE	TERRITORY	COUNTY	TERMS	COLORS
Nathan	8/18/2020	TN	Williamson	Net 15	TBD

PART NUMBER	QUANTITY	DESCRIPTION	UNIT PRICE	TOTAL
R5068178B	1	Custom Playcraft 5-12YR Ramped Treehouse Structure	\$ 192,822.00	\$ 192,822.00
NEPTUN.20	1	Custom Berliner Neptun.20	\$ 72,740.00	\$ 72,740.00
R507089DA	1	Custom Playcraft 2-5YR Treehouse Structure	\$ 60,622.00	\$ 60,622.00
PC 2445	1	Double UltraZip w/ (1) Inclusive Seat and (1) Zip Line Seat	\$ 28,600.00	\$ 28,600.00
FNHP	1	Freenotes Instruments - Drums, Imbarimba, Swirl and Griffin	\$ 21,669.00	\$ 21,669.00
PC 6263	1	Friendship Spinner Inclusive Ground Level Merry Go Round	\$ 16,607.00	\$ 16,607.00
PC 1375	1	Multi-Spring Forest Service Truck	\$ 8,370.00	\$ 8,370.00
TC001	1	ID Sculptures GFRC Bear Cub	\$ 8,941.00	\$ 8,941.00
AP009	1	ID Sculptures GFRC Balance Log	\$ 5,625.00	\$ 5,625.00
PC 2015	1	Steel 3-Bay Arch Swing w/ Tire Swing and (2) Belts	\$ 7,143.00	\$ 7,143.00
PC 2120	1	Steel 2-Bay Arch Swing - (1) Full Bucket, (1) Playshare, (2) ADA	\$ 6,880.00	\$ 6,880.00
MISCELLANEOUS	6	6' Long Park Bench w/ Backrest	\$ 650.00	\$ 3,900.00
				\$ -
<b>SUBTOTAL FOR EQUIPMENT</b>				\$ 433,919.00
<i>Certified Southern-Built™ Installation</i>				\$ 130,175.00
SAFETY SURFACE	12053	Engineered Wood Fiber Safety Surface	\$ 1.55	\$ 18,682.15
		<i>Average Depth: 9" Compacted, Color N/A</i>		
SAFETY SURFACE	3325	Unitary Bonded Rubber Safety Surface	\$ 12.50	\$ 41,562.50
		<i>Average Depth: 3.5", Color TBD</i>		
SURFACE SUBSTRATE	3062	3" Compacted Crushed Stone Substrate	\$ 2.25	\$ 6,889.50
BORDER	650	Concrete Curb Containment Border	\$ 21.00	\$ 13,650.00
CONCRETE	275	Concrete Pad for Music Equipment	\$ 7.50	\$ 2,062.50
MAINTENANCE	19	Swing/Slide Mats - 3'x5'x2' 135lbs	\$ 200.00	\$ 3,800.00
				\$ -
DISCOUNT	10%	OMNIA PURCHASING CONTRACT DISCOUNT		\$ (43,391.90)
<b>SUBTOTAL</b>				\$ 607,348.75

TAX RATE	7.00%
SALES TAX	-

BONDS	
EQUIPMENT FREIGHT	28,693.00
SURFACE FREIGHT	4,240.00

**TERMS** \$ 540,281.75

Partial Community Build



1-800-390-8438  
www.GreatSouthernRec.com

Beautiful Outdoor Spaces, we can ALL be proud of.

<b>ORGANIZATION:</b>	Bowie Nature Park Playground Committee
<b>CONTACT:</b>	Scott McCoy
<b>ADDRESS:</b>	7100 City Center Circle, Fairview, TN 37062
<b>PHONE:</b>	615-799-2002

<b>PROJECT TITLE:</b>	Bowie Park Replacement
<b>REVISION:</b>	1
<b>OPTION:</b>	1 - Partial Community Build

**Official Quote from Great Southern Recreation**

TERRITORY MANAGER	DATE	TERRITORY	COUNTY	TERMS	COLORS
Nathan	8/18/2020	TN	Williamson	Net 15	TBD

PART NUMBER	QUANTITY	DESCRIPTION	UNIT PRICE	TOTAL
RS068178B	1	Custom Playcraft 5-12YR Ramped Treehouse Structure	\$ 192,822.00	\$ 192,822.00
NEPTUN.20	1	Custom Berliner Neptun.20	\$ 72,740.00	\$ 72,740.00
RS070690A	1	Custom Playcraft 2-5YR Treehouse Structure	\$ 60,622.00	\$ 60,622.00
PC 2445	1	Double UltraZip w/ (1) Inclusive Seat and (1) Zip Line Seat	\$ 28,600.00	\$ 28,600.00
FNHP	1	Freemotes Instruments - Drums, Imbarimba, Swirl and Griffin	\$ 21,669.00	\$ 21,669.00
PC 6263	1	Friendship Spinner Inclusive Ground Level Merry Go Round	\$ 16,607.00	\$ 16,607.00
PC 1375	1	Multi-Spring Forest Service Truck	\$ 8,370.00	\$ 8,370.00
TC001	1	ID Sculptures GFRC Bear Cub	\$ 8,941.00	\$ 8,941.00
AP009	1	ID Sculptures GFRC Balance Log	\$ 5,625.00	\$ 5,625.00
PC 2015	1	Steel 3-Bay Arch Swing w/ Tire Swing and (2) Belts	\$ 7,143.00	\$ 7,143.00
PC 2120	1	Steel 2-Bay Arch Swing - (1) Full Bucket, (1) Playshare, (2) ADA	\$ 6,880.00	\$ 6,880.00
MISCELLANEOUS	6	6' Long Park Bench w/ Backrest	\$ 650.00	\$ 3,900.00
				\$ -
<b>SUBTOTAL FOR EQUIPMENT</b>				\$ 433,919.00
<b>Certified Southern-Track™ Installation</b>				\$ 125,175.00
<b>SAFETY SURFACE</b>	12053	Engineered Wood Fiber Safety Surface <i>Average Depth: 9" Compacted, Color N/A</i>	\$ 0.75	\$ 9,039.75
<b>SAFETY SURFACE</b>	3325	Unitary Bonded Rubber Safety Surface <i>Average Depth: 3.5", Color TBD</i>	\$ 12.50	\$ 41,562.50
<b>SURFACE SUBSTRATE</b>	3062	3" Compacted Crushed Stone Substrate	\$ 2.25	\$ 6,889.50
<b>BORDER</b>	650	Concrete Curb Containment Border	\$ 21.00	\$ 13,650.00
<b>CONCRETE</b>	275	Concrete Pad for Music Equipment	\$ 7.50	\$ 2,062.50
<b>MAINTENANCE</b>	19	Swing/Slide Mats - 3'x5'x2' 135lbs	\$ 200.00	\$ 3,800.00
<b>DISCOUNT</b>	10%	<b>OMNIA PURCHASING CONTRACT DISCOUNT</b>		\$ (43,391.90)
<b>SUBTOTAL</b>				\$ 592,706.35

<b>TAX RATE</b>	7.00%
<b>SALES TAX</b>	-

<b>BONDS</b>	
<b>EQUIPMENT FREIGHT</b>	28,693.00
<b>SURFACE FREIGHT</b>	4,240.00

**TOTAL** \$ 625,639.35

Full Community Build



1-800-390-8438  
www.GreatSouthernRec.com

Beautiful Outdoor Spaces, we can ALL be proud of.

<b>ORGANIZATION:</b>	Bowie Nature Park Playground Committee
<b>CONTACT:</b>	Scott McCoy
<b>ADDRESS:</b>	7100 City Center Circle, Fairview, TN 37062
<b>PHONE:</b>	615-799-2002

<b>PROJECT TITLE:</b>	Bowie Park Replacement
<b>REVISION:</b>	1
<b>OPTION:</b>	1 - Full Community Build

**Official Quote from Great Southern Recreation**

TERRITORY MANAGER	DATE	TERRITORY	COUNTY	TERMS	COLORS
Nathan	8/18/2020	TN	Williamson	Net 15	TBD

PART NUMBER	QUANTITY	DESCRIPTION	UNIT PRICE	TOTAL
R506B178B	1	Custom Playcraft 5-12YR Ramped Treehouse Structure	\$ 192,822.00	\$ 192,822.00
NEPTUN.20	1	Custom Berliner Neptun.20	\$ 72,740.00	\$ 72,740.00
R507069DA	1	Custom Playcraft 2-5YR Treehouse Structure	\$ 60,622.00	\$ 60,622.00
PC 2445	1	Double UltraZip w/ (1) Inclusive Seat and (1) Zip Line Seat	\$ 28,600.00	\$ 28,600.00
FNHP	1	Freenotes Instruments - Drums, Imbarimba, Swirl and Griffin	\$ 21,669.00	\$ 21,669.00
PC 6263	1	Friendship Spinner Inclusive Ground Level Merry Go Round	\$ 16,607.00	\$ 16,607.00
PC 1375	1	Multi-Spring Forest Service Truck	\$ 8,370.00	\$ 8,370.00
TC001	1	ID Sculptures GFRC Bear Cub	\$ 8,941.00	\$ 8,941.00
AP009	1	ID Sculptures GFRC Balance Log	\$ 5,625.00	\$ 5,625.00
PC 2015	1	Steel 3-Bay Arch Swing w/ Tire Swing and (2) Belts	\$ 7,143.00	\$ 7,143.00
PC 2120	1	Steel 2-Bay Arch Swing - (1) Full Bucket, (1) Playshare, (2) ADA	\$ 6,880.00	\$ 6,880.00
MISCELLANEOUS	6	6' Long Park Bench w/ Backrest	\$ 650.00	\$ 3,900.00
<b>SUBTOTAL FOR EQUIPMENT</b>				\$ 433,919.00
<b>Certified Southern-Install™ Installation</b>				\$ 20,000.00
SAFETY SURFACE	12053	Engineered Wood Fiber Safety Surface <i>Average Depth: 9" Compacted, Color N/A</i>	\$ 0.75	\$ 9,039.75
SAFETY SURFACE	3325	Unitary Bonded Rubber Safety Surface <i>Average Depth: 3.5", Color TBD</i>	\$ 12.50	\$ 41,562.50
SURFACE SUBSTRATE	3062	3" Compacted Crushed Stone Substrate	\$ 2.25	\$ 6,889.50
BORDER	650	Concrete Curb Containment Border	\$ 21.00	\$ 13,650.00
CONCRETE	275	Concrete Pad for Music Equipment	\$ 7.50	\$ 2,062.50
MAINTENANCE	19	Swing/Slide Mats - 3'x5'x2' 135lbs	\$ 200.00	\$ 3,800.00
DISCOUNT	10%	OMNIA PURCHASING CONTRACT DISCOUNT		\$ (43,391.90)
<b>SUBTOTAL</b>				\$ 487,531.35

TAX RATE	7.00%
SALES TAX	-

BONDS	
EQUIPMENT FREIGHT	28,693.00
SURFACE FREIGHT	4,240.00

<b>TOTAL</b>	\$ 520,464.35
--------------	---------------

## Community Build Scenario – Construction Options

### Community Build Info



We are enclosing 3 different construction options for each included design:

**1) Base Quote** - The first quote is a fully turn-key build price where our in-house construction crew provides all the labor, materials and machinery to complete the playground installation, from safety surfacing to play equipment. All you have to do is give us access to the park!

**2) Partial Community Build** - The second pricing scenario gives a deduct for a 'Partial Community Build'. This scenario could be done in a variety of ways, but for the purpose of pricing the RFP, we are proposing that the Partial Community Build consist of Great Southern installing all of the major equipment footers, tall towers/roofs and anything heavy enough for the City of Fairview to not want liability for. Great Southern would oversee a 3-day volunteer weekend (Fri/Sat/Sun) where community volunteers could sign up for a 4 hour shift to work on the playground build (8AM-12PM and 1PM-5PM shifts). This would be a great way for the community to have some 'sweat equity' and communal involvement in the new playground but also distance the City from liability of the heavy construction items on the playground. The scope of the community build days would include moving and installing loose fill wood mulch, installing individual play components (panels, slides and climbers), hanging/setting swings and assembling benches/tables. In this scenario, the volunteer group would be responsible for providing minimal equipment on the community build days, mostly limited to wheelbarrels, shovels, rakes, hammers and drills, basic tools most any citizen would already have.

**3) Full Community Build** - The third pricing scenario gives a deduct for a 'Full Community Build'. In this scenario, Great Southern would only provide 2-3 of our installation crew members to help guide the volunteer group through the installation process. Great Southern would provide a schedule of work to be done and organize volunteer sign ups. Great Southern would also ensure that the installation work is done to manufacturer's specifications and meets the requirements of the ASTM/CPSC and ADA guidelines. A sample schedule and list of materials/construction machinery to be provided by the volunteer group is listed on the following page. If the City is capable of having all of these items donated, this along with volunteer labor, could provide monetary savings that would allow for additional playground equipment. However, Great Southern Recreation will not be able to extend the labor warranty (the manufacturer's warranties would remain intact). It is possible that if the City ends up having to pay for materials and machine rentals out of pocket, they might not find the increased liability and strain on local resources worth the effort of the full community build. But, we are happy to help assess this further with you.

The full community build option would still include Great Southern installing any poured rubber or artificial turf safety surface. It is important to note that in addition to the concrete requirements, heavy and light equipment requirements and volunteer labor, the City would also be responsible for survey and location of the equipment footer posts. Additional info on requirements included in the following pages.



Great Southern Recreation  
2441-Q Old Fort Parkway  
Murfreesboro, TN 37128  
1-800-390-8438  
[www.GreatSouthernRec.com](http://www.GreatSouthernRec.com)

## **Bowie Park Playground Community Build** **Option 1 Sample List**

### **Concrete Requirements**

#### **Concrete For Equipment Footers – 80lb. Bags Concrete – 3000 PSI**

##### 5-12YR Play Area

- Large Ramped Play Structure – 538 Bags
- Concrete Pad for Music Equipment – 152 Bags
  - 3-Bay Swing – 64 Bags
  - Friendship Spinner – 35 Bags
  - Double UltraZip – 128 Bags
  - GFRC Bear Cub – 33 Bags
  - GFRC Balance Log – 20 Bags
  - (3) Benches – 12 Bags

##### 2-5YR Play Area

- Play Structure – 226 bags
- 2-Bay Swing – 48 Bags
- Forest Service Truck – 12 Bags
- (3) Benches – 12 Bags

**Total:** 1,280 80lb. Bags Concrete (3000 PSI) – About 30 Yards



Great Southern Recreation  
2441-Q Old Fort Parkway  
Murfreesboro, TN 37128  
1-800-390-8438  
[www.GreatSouthernRec.com](http://www.GreatSouthernRec.com)

**Bowie Park Playground Community Build**  
**Option 1 Sample List**

**Equipment Requirements**

**Heavy Equipment Required**

- Footers for all playground equipment will need to be dug/augered – About 115 Large Footer Holes (18” Diameter x 30” Deep) and 70 Small Footer Holes (12” Diameter x 18” Deep). Will need at least 2 tractors or skid steers with 12” and 18” Auger Bits
- At least 2 skid steers with fork and bucket attachments. Fork attachments to unload playground equipment and move heavy equipment pallets around site. Bucket attachment to re-grade surfaced area after equipment installation and prior to surfacing installation. Bucket attachments can be used to help install wood fiber safety surfacing.
- Scaffolding set or man lift to install structure sunshade attachments.
  - Carry Deck Crane with minimum 5 ton capacity
  - Transit level for shooting grade and locating post holes



Great Southern Recreation  
2441-Q Old Fort Parkway  
Murfreesboro, TN 37128  
1-800-390-8438  
[www.GreatSouthernRec.com](http://www.GreatSouthernRec.com)

## **Bowie Park Playground Community Build** **Option 1 Sample List**

### **Equipment Requirements**

#### **Standard Hand Tool Loose Equipment Required**

- 2" x 8" Treated Lumber Cut Into 8" x 8" Squares – One Square Per Footing Hole.
- One set of tools for every four volunteers. .i.e. 12 volunteers = 3 sets of tools.
- Ratchet/Socket Wrenches ((9/16", 3/4", 1/2", etc.)
- Open end wrenches - up to 3/4"
- Torx Head wrenches & sockets (T-27, T-30, T-45, T-55) Carried @ NAPA
- 1/2" Power Drills with metal drill bits – up to 9/16"
- Impact Guns (7-8)
- Tape Measurer
- Levels (9" magnetic, 2' & 4')
- Vice grips & C-Clamps
- Drift Pins/Alignment Punches
- Utility Knives
- Hammers/Sledges – Standard & Rubber
- Screwdrivers
- Cordless Drills with 3" Tip Extensions
- 3/8" Nut Driver For Drills
- 3/8" Coarse Thread Tap (16 Threads Per Inch)
- Several Post Hole Diggers
- As many wheelbarrows, shovels and rakes as can be brought (for bringing in wood fiber surface)



## Fundraising Projections

Current Community Fundraising Balance: **\$21,220.23**

With Covid-19 restrictions and conditions, fundraising projections are subject to greater uncertainties:

- Limitations on gatherings and events (BBQ event, car shows, car washes, etc.)
- Potentially less funding available from corporate sponsors (slowdown in revenue and increased expenses)
- Potentially less funding available from individual donors (negative discretionary income impacts)

That said the Playground Build Group believes we can raise funds according to the estimate schedule below:

Cumulative Balance	Fundraising Source				
\$21,220	\$21,220	Current Balance			
\$21,220		<b>2020 Q4 - \$5,000</b>			
\$26,220	\$5,000	Individual Contributions			
\$26,220		<b>2021 Q1 - \$15,000</b>			
\$31,220	\$5,000	Individual Contributions			
\$41,220	\$10,000	Individual Sponsorships (placards, bricks)			
\$41,220		<b>2021 Q2 - \$38,000</b>			
\$44,220	\$3,000	Individual Contributions			
\$54,220	\$10,000	Individual Sponsorships (placards, bricks)			
\$69,220	\$15,000	Corporate Sponsorships (equipment, placards, bricks)			
\$84,220	\$15,000	Events (BBQ, Carshow, carwash, etc.)			
\$84,220		<b>2021 Q3 - \$29,000</b>			
\$87,220	\$3,000	Individual Contributions			
\$97,220	\$10,000	Individual Sponsorships (placards, bricks)			
\$112,220	\$15,000	Corporate Sponsorships (equipment, placards, bricks)			
\$118,220	\$6,000	Events			
\$118,220		<b>2021 Q4 - \$29,000</b>			
\$121,220	\$3,000	Individual Contributions			
\$131,220	\$10,000	Individual Sponsorships (placards, bricks)			
\$146,220	\$15,000	Corporate Sponsorships (equipment, placards, bricks)			
\$152,220	\$6,000	Events			

Note that we will explore funding in grants – we can begin the process of review, qualification, eligibility, and application with a final approved design. We also believe we may find some material donations or discounts on materials such as mulch.

CITY OF FAIRVIEW, TENNESSEE

RESOLUTION NO. 19-20



A RESOLUTION OF THE CITY OF FAIRVIEW, TENNESSEE, AUTHORIZING THE  
MAYOR TO EXECUTE AN EXTENSION OF CONTRACT 160087 RELATING TO THE  
BOWIE LAKE ROAD TO PARK VILLAGE COURT SIDEWALK PROJECT.

**WHEREAS**, the City of Fairview Board is currently contracted with the State of Tennessee for the extension of a sidewalk on the east side of Highway 100 from Bowie Lake Road to Park Village Court, and

**WHEREAS**, the city has received approval from the state for an extension of time to complete certain provisions of this contract, and

**WHEREAS**, the extension is necessary for the purchase of right(s) of way related to this project, and

**WHEREAS**, this project was previously approved and is funded with 5% city dollars and 95% state and federal dollars, not to exceed \$950,000 total, and

**NOW, THEREFORE, BE IT RESOLVED BY THE BOARD OF COMMISSIONERS OF THE CITY OF FAIRVIEW, TENNESSEE, AS FOLLOWS:**

The City of Fairview Board of Commissioners hereby resolves to authorize the mayor to execute contract extension #2 for contract 160087, PIN 123627.00, related to the installation of a sidewalk from Bowie Lake Road to Park Village Court.

\_\_\_\_\_  
Mayor

Attest:

\_\_\_\_\_  
City Recorder

Approved As To Form:

\_\_\_\_\_  
City Attorney

**AMENDMENT TWO  
OF GRANT CONTRACT 160087, PIN 123627.00**

This Grant Contract Amendment is made and entered by and between the State of Tennessee, Department of Transportation, hereinafter referred to as the "State" and City of Fairview, hereinafter referred to as the "Grantee." It is mutually understood and agreed by and between said, undersigned contracting parties that the subject Grant Contract is hereby amended as follows:

- 1. Grant Contract section B.1. is deleted in its entirety and replaced with the following:

**"B. CONTRACT PERIOD:**

B.1. The Agency agrees to complete the herein assigned phases of the Project on or before August 9, 2021. If the Agency does not complete the herein described phases of the Project within this time period, this Agreement will expire on the last day of scheduled completion as provided in this paragraph unless an extension of the time period is requested by the Agency and granted in writing by the Department prior to the expiration of the Agreement. An extension of the term of this Agreement will be effected through an amendment to the Agreement. Expiration of this Agreement will be considered termination of the Project. The cost of any work performed after the expiration date of the Agreement will not be reimbursed by the Department."

- 2. Required Approvals. The State is not bound by this Amendment until it is signed by the contract parties and approved by appropriate officials in accordance with applicable Tennessee laws and regulations (depending upon the specifics of this contract, said officials may include, but are not limited to, the Commissioner of Finance and Administration, the Commissioner of Human Resources, and the Comptroller of the Treasury).
- 3. Amendment Effective Date. The revisions set forth herein shall be effective \_\_\_\_\_, All other terms and conditions of this Grant Contract not expressly amended herein shall remain in full force and effect.

**IN WITNESS WHEREOF,**

**CITY OF FAIRVIEW**

---

**JOHN BLADE, AGENCY SIGNATURE**

**DATE**

---

**PRINTED NAME AND TITLE OF AGENCY SIGNATORY (above)**

**APPROVED AS TO FORM AND LEGALITY**

---

**TIMOTHY POTTER, AGENCY ATTORNEY**

**DEPARTMENT OF TRANSPORTATION:**

---

**CLAY BRIGHT, COMMISSIONER**

**DATE**

**APPROVED AS TO FORM AND LEGALITY**

---

**JOHN REINBOLD, GENERAL COUNSEL**

CITY OF FAIRVIEW, TENNESSEE

RESOLUTION NO. 20-20



A RESOLUTION OF THE CITY OF FAIRVIEW, TENNESSEE, DI  
VEHICLE AND EQUIPMENT AS SURPLUS, AND AUTHORIZING THE DISPOSAL OF  
THESE SURPLUS ITEMS.

WHEREAS, the Board of Commissioners desires to continue to maintain the city's  
vehicle and equipment fleet in the most efficient and cost-effective manner, and

WHEREAS, this vehicle and equipment have exhausted their useful service life  
and should be designated as surplus to be removed from the fleet or inventory, and

WHEREAS, the proceeds from sale or of these items shall be remitted to the city's  
capital account, and

WHEREAS, the vehicle and equipment to be designated as surplus and auctioned  
and sold are as follows:

2011 Chevrolet Tahoe, VIN 1GNLC2E04BR177343, and the currently installed  
emergency lighting and storage equipment, and

WHEREAS, the town of Chapel Hill, Tennessee, desires to purchase the vehicle  
and equipment for \$5,500, and

**NOW, THEREFORE, BE IT RESOLVED BY THE BOARD OF COMMISSIONERS  
OF THE CITY OF FAIRVIEW, TENNESSEE, AS FOLLOWS:**

The City of Fairview Board of Commissioners hereby resolves to and does declare the  
vehicle and equipment described above as surplus and hereby authorizes the sale of  
these items to the Town of Chapel Hill, Tennessee, for the sum of \$5,500. Should the  
Town of Chapel Hill not purchase the vehicle and equipment the items shall be sold by  
online auction.

\_\_\_\_\_  
Mayor

\_\_\_\_\_  
Date Approved

Attest:

\_\_\_\_\_  
City Recorder

Approved As To Form:

\_\_\_\_\_  
City Attorney



# NADAguides Value Report 8/26/2020

## 2011 Chevrolet Tahoe Utility 4D Police 2WD

[CHANGE CAR](#) [COMPARE](#)

### Values

	Rough Trade-In	Average Trade-In	Clean Trade-In	Clean Retail
Base Price	\$5,025	\$6,200	\$7,175	\$9,675
Mileage (112,000)	\$300	\$300	\$300	\$300
<b>Total Base Price</b>	<b>\$5,325</b>	<b>\$6,500</b>	<b>\$7,475</b>	<b>\$9,975</b>

### Options

<b>Price + Options</b>	<b>\$5,325</b>	<b>\$6,500</b>	<b>\$7,475</b>	<b>\$9,975</b>
------------------------	----------------	----------------	----------------	----------------

Selling Your Car? Get an Online Offer in 2 Minutes.